

PaxTower



ZARGES



PaxTower

Quick assembly. Optimal stability. Safe access.

NEW

www.zarges.com/paxtower

ZARGES PaxTower S-Plus 1T and 1T – convenient one-click folding scaffold towers.

When you are working at height on scaffold towers, it is essential that they offer stability, secure footing and simple, flexible handling. The new PaxTower folding scaffold unit stands out with a working height of up to 7.65 m as well as three unique features: smooth-sliding guides made of hard plastic for easy connection of push-on end frames, a folding mechanism that can be operated with one hand, and a simple-to-use toeboard unit.



Advantages:

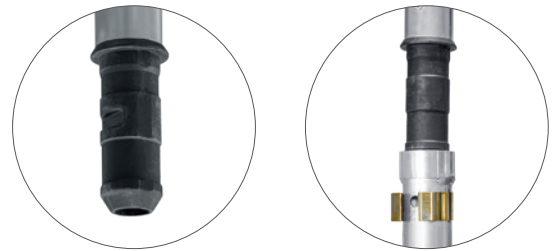

Smooth-sliding guides made of hard plastic:

prevent misalignment when connecting push-on end frames together

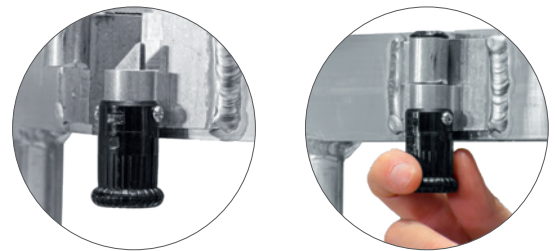

One-handed operation of the folding frame featuring a sturdy lock button:

engage or release the lock with simple click

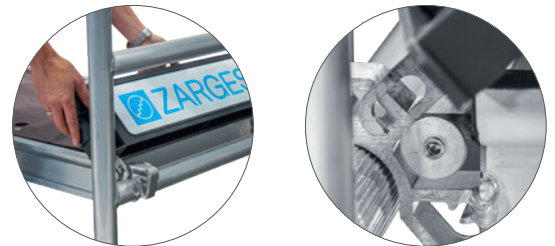

Patented toeboard unit:

quick to install

Moving away from plastic packaging for greater sustainability

During delivery, ZARGES PaxTower components are secured together using straps **without any plastic packaging**.

ZARGES is currently already putting the **EU Circular Economy Package** into action.

This is another step taken by ZARGES towards greater sustainability in its product development and production through adopting **resource-efficient processes** and creating **durable products**.



PaxTower S-PLUS 1T – with advanced guardrail in compliance with the new EN 1004.

Advantages

- Safer and quicker assembly and dismantling due to advanced guardrails and platforms at intervals of 2 m.
- One-handed operation of the folding frame featuring a sturdy lock button: engage or release the lock with simple click.
- Patented toeboard unit: quick to install.
- Smooth-sliding guides made of hard plastic: prevent misalignment when connecting push-on end frames together.

Technical data

- Scaffolding length: 1.80 m; scaffolding width: 0.72 m.
- Scaffolding Category 3 (load capacity of up to 200 kg/m²) according to the new EN 1004.
- 125 mm swivel castors with brake; the castors can be fitted with castor adapters (order no. 42974) to allow for height adjustment.
- Stile and rung diameter 45 mm.

NEW



Platform sizes:

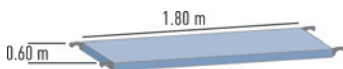

Please order the corresponding packs to extend the PaxTower.



| | Base pack / Size 1 | Size 2 | Size 3 | Size 4 | Size 5 | Size 6 |
|-------------------|--------------------|--------|--------|--------|--------|--------|
| Working height m | 2.55 | 3.55 | 4.55 | 5.55 | 6.55 | 7.55 |
| Scaffold height m | 1.65 | 2.65 | 3.65 | 4.65 | 5.65 | 6.65 |
| Platform height m | 0.55 | 1.55 | 2.55 | 3.55 | 4.55 | 5.55 |

| Platform size 0.60 m × 1.80 m | | | | | | |
|-------------------------------|--------------|-------|-------|-------|-------|-------|
| Weight kg | 29.1/38.3 | 71.4 | 79.5 | 108.0 | 114.1 | 142.6 |
| Order no. | 53510*/53521 | 53522 | 53523 | 53524 | 53525 | 53526 |

*Order no. 53510 (Base pack) by itself does not comply with the new EN 1004: 2020 (effective from Nov. 2020) for mobile work platforms. The "EN 1004 add-on pack" (order no. 53550) must be ordered in addition to ensure compliance. Ballast weights not included in the scope of delivery.





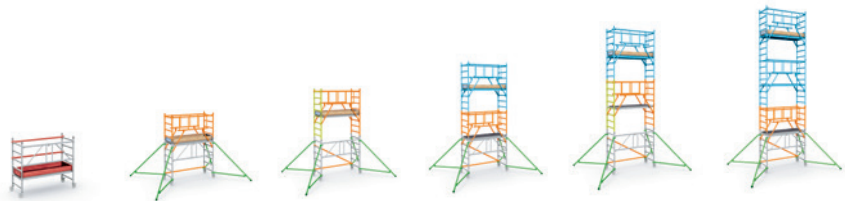

| Ballast | Order no. | Number of ballast weights per swivel castor | | | | | |
|-------------|-----------|---|---|---|---|---|---|
| Indoor use | 42792 | 1 | 0 | 0 | 0 | 0 | 0 |
| Outdoor use | | 1 | 0 | 0 | 0 | 1 | 3 |

Observe the ballasting requirements in the assembly and use instructions!



Packs for PaxTower S-PLUS 1T



| S-PLUS 1T packs | Order no. | Size 1 | Size 2 | Size 3 | Size 4 | Size 5 | Size 6 |
|--|-----------|--------|--------|--------|--------|--------|--------|
| Order no. | | 53521 | 53522 | 53523 | 53524 | 53525 | 53526 |
|  Base pack | 53510 | 1 | 1 | 1 | 1 | 1 | 1 |
|  EN 1004 add-on pack | 53550 | 1 | - | - | - | - | - |
|  Stabiliser pack | 53551 | - | 1 | 1 | 1 | 1 | 1 |
|  Toeboard pack | 53552 | - | 1 | 1 | 1 | 1 | 1 |
|  One-metre extension pack S-PLUS | 53558 | - | 1 | 1 | 1 | 1 | 1 |
|  Two-metre push-on end frame S-PLUS | 53559 | - | - | - | 1 | 1 | 2 |
|  Two-metre push-on end frame | 42782 | - | - | 1 | - | 1 | - |

Note: Please ask us about the delivery times and prices for other components or spare parts where necessary

PaxTower – components and accessories

Swivel castor

Plastic wheel, Ø 125 mm, with lockable plastic pin and brake.
Delivery size: 1 piece.

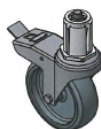

| Weight kg | Order no. |
|-----------|-----------|
| 1.3 | 42790 |

Ballast weight (cuboid)

Steel, painted. With clamps for attachment to stabilisers.
Colour: Yellow.



| Weight kg | Order no. |
|-----------|-----------|
| 10.0 | 42792 |

Castor adapter

Adapter that can be screwed onto a swivel castor (order no. 42790) to provide height adjustment.

- Adjustment range: 6.5 cm.
- Delivery size: 1 PU = 4 pieces.



| Weight kg | Order no. |
|-----------|-----------|
| 3.2 | 42794 |

PaxTower 1T – in compliance with the new EN 1004.

Advantages

- One-handed operation of the folding frame featuring a sturdy lock button: engage or release the lock with simple click.
- Patented toeboard unit: quick to install.
- Smooth-sliding guides made of hard plastic: prevent misalignment when connecting push-on end frames together.

Technical data

- Scaffolding length: 1.80 m; scaffolding width: 0.72 m.
- Scaffolding Category 3 (load capacity of up to 200 kg/m²) according to the new EN 1004.
- Fitted with 125 mm swivel castors with brake; the castors can be fitted with castor adapters (order no. 42974) to allow for height adjustment.
- Stile and rung diameter 45 mm.

NEW



Platform sizes:

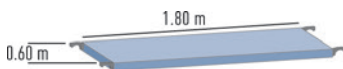

| | Base pack / Size 1 | Size 2 | Size 3 | Size 4 | Size 5 | Size 6 |
|-------------------|--------------------|--------|--------|--------|--------|--------|
| Working height m | 2.55 | 3.55 | 4.55 | 5.55 | 6.55 | 7.55 |
| Scaffold height m | 1.65 | 2.65 | 3.65 | 4.65 | 5.65 | 6.65 |
| Platform height m | 0.55 | 1.55 | 2.55 | 3.55 | 4.55 | 5.55 |

| Platform size 0.60 m × 1.80 m | | | | | | |
|-------------------------------|--------------|-------|-------|-------|-------|-------|
| Weight kg | 29.1/38.3 | 68.0 | 78.0 | 95.3 | 111.2 | 130.4 |
| Order no. | 53510*/53511 | 53512 | 53513 | 53514 | 53515 | 53516 |

*Order no. 53510 (Base pack) by itself does not comply with the new EN 1004: 2020 (effective from Nov. 2020) for mobile work platforms. The "EN 1004 add-on pack" (order no. 53550) must be ordered in addition to ensure compliance. Ballast weights not included in the scope of delivery.

| Ballast | Order no. | Number of ballast weights per swivel castor | | | | | |
|-------------|-----------|---|---|---|---|---|---|
| Indoor use | 42792 | 1 | 0 | 0 | 0 | 0 | 0 |
| Outdoor use | | 1 | 0 | 0 | 0 | 1 | 3 |

Observe the ballasting requirements in the assembly and usage manual!



Packs for PaxTower 1T

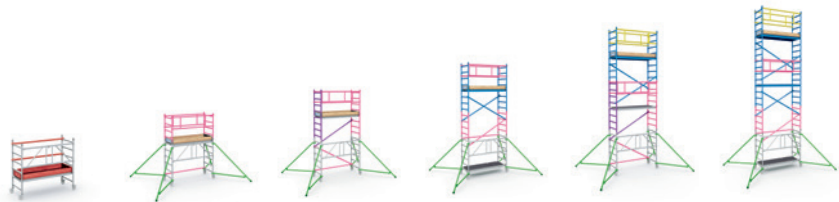

| 1T packs | Order no. | Size 1 | Size 2 | Size 3 | Size 4 | Size 5 | Size 6 |
|-----------------------------|-----------|--------|--------|--------|--------|--------|--------|
| Order no. | | 53511 | 53512 | 53513 | 53514 | 53515 | 53516 |
| Base pack | 53510 | 1 | 1 | 1 | 1 | 1 | 1 |
| EN 1004 add-on pack | 53550 | 1 | - | - | - | - | - |
| Stabiliser pack | 53551 | - | 1 | 1 | 1 | 1 | 1 |
| Toeboard pack | 53552 | - | 1 | 1 | 1 | 1 | 1 |
| One-metre extension pack 1T | 53553 | - | 1 | 1 | 1 | 1 | 1 |
| Two-metre extension pack 1T | 53554 | - | - | - | 1 | 1 | 2 |
| Two-metre add-on frame 1T | 53555 | - | - | 1 | - | 1 | - |
| Guardrail pack 1T | 53556 | - | - | - | - | 1 | 1 |

PaxTower – components and accessories

Note: Please ask us about the delivery times and prices for other components or spare parts where necessary

Swivel castor

Plastic wheel, Ø 125 mm, with lockable pin and brake.
Delivery size: 1 piece.

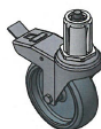

| Weight kg | Order no. |
|-----------|-----------|
| 1.3 | 42790 |

Ballast weight (cuboid)

Steel, painted. With clamps for attachment to stabilisers.
Colour: Yellow.



| Weight kg | Order no. |
|-----------|-----------|
| 10.0 | 42792 |

Castor adapter

Adapter that can be screwed onto a swivel castor (order no. 42790) to provide height adjustment.

- Adjustment range: 6.5 cm.
- Delivery size: 1 PU = 4 pieces.



| Weight kg | Order no. |
|-----------|-----------|
| 3.2 | 42794 |



ZARGES –
 Access.
 Packaging,
 transportation.
 Special solutions.

For more than 85 years, the brand name ZARGES has been synonymous with premium quality and continuous innovation. As an innovation leader, we are constantly improving our range and creating solutions and products that are consistently tailored to your needs. And good ideas always come from closely working together with you, the customer.

Our aim is to always provide you, the professional, with the right solution for any requirement. For your safety and efficiency.

www.zarges.com/paxtower

Further information is available online or from your specialist retailer:

